

PLEASE CHECK WWW.MOLEX.COM FOR LATEST PART INFORMATION

Part Number: **0673450000**
Status: **Active**
Description: 0.80mm (.031") Pitch SODIMM Socket, Right Angle, SMT, Reverse Mount, 5.20mm (.205") Mounted Height, 144 Circuits, 3.3V Power Supply, Soft Tray Packaging

Documents:

[3D Model](#) [RoHS Certificate of Compliance \(PDF\)](#)
[Drawing \(PDF\)](#)

General

Product Family	Memory Module Sockets
Series	67345
Comments	3.3V Power Supply
Component Type	Socket
JEDEC Outline	N/A
Product Name	S.O. DIMM

Physical

Circuits (Loaded)	144
Durability (mating cycles max)	30
Entry Angle	90° Angle (Side Entry)
Keying to Mating Part	Yes
Material - Plating Mating	Gold
PCB Retention	Yes
PCB Thickness Recommended (in)	0.045 In
PCB Thickness Recommended (mm)	1.20 mm
Packaging Type	Tray
Pitch - Mating Interface (in)	0.031 In
Pitch - Mating Interface (mm)	0.80 mm
Temperature Range - Operating	-55°C to +85°C
Termination Interface: Style	Surface Mount

Electrical

Current - Maximum per Contact	0.3A
Voltage - Maximum	100V
Voltage Key	3.3V

Material Info

Reference - Drawing Numbers

Product Specification	RPS-54698-004
Sales Drawing	SD-67345-001

EU RoHS **China RoHS**

Compliance Status

Not Reviewed

REACH SVHC

Not Reviewed

Halogen-Free

Status

Not Reviewed

Need more information on product environmental compliance?

Email productcompliance@molex.com
 For a multiple part number RoHS Certificate of Compliance, [click here](#)

Please visit the [Contact Us](#) section for any non-product compliance questions.

Search Parts in this Series

[67345Series](#)

Mates With

JEDEC Standard DRAM and SDRAM modules

10 9 8 7 6 5 4 3 2 1

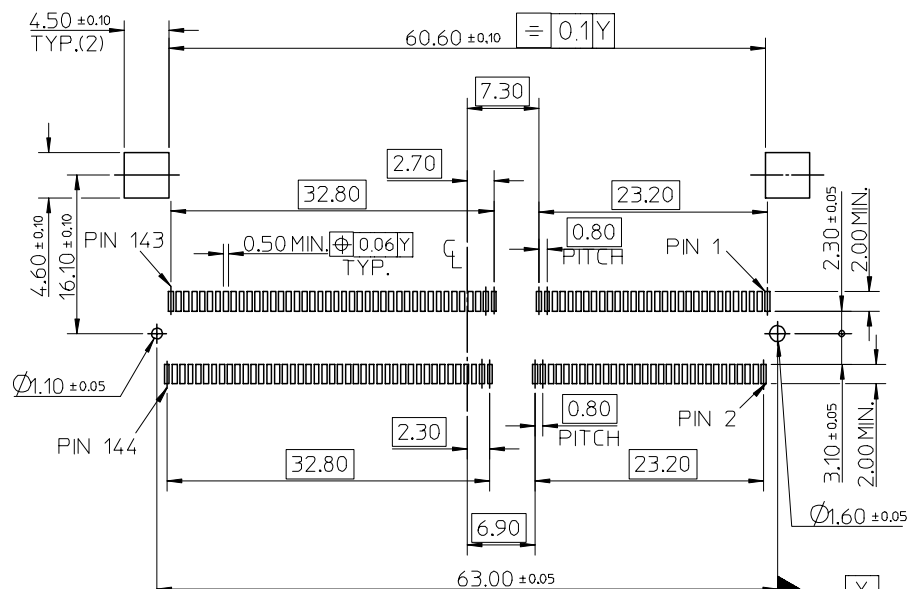
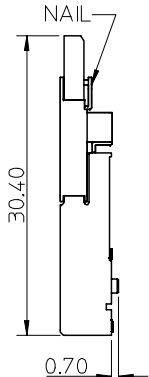
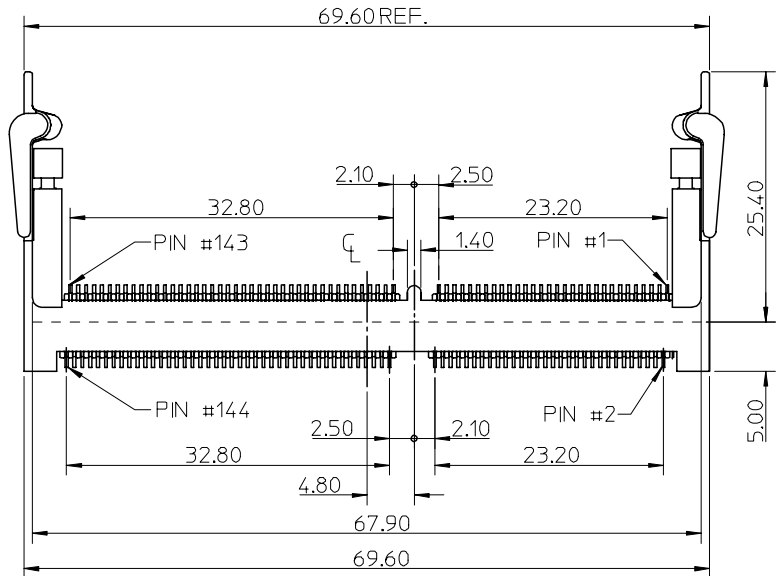
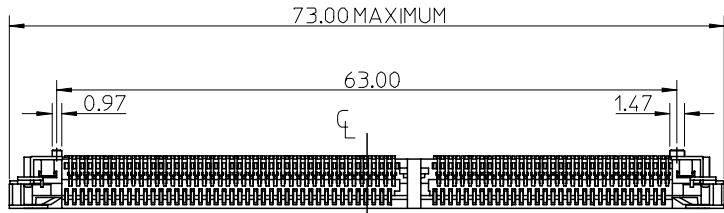

RECOMMENDED PCB PATTERN LAYOUT

NOTES:

- MATERIAL
HOUSING - HIGH TEMPERATURE PLASTIC, GLASS FILL, UL 94V-0
TERMINAL - COPPER ALLOY
NAIL - COPPER ALLOY
- FINISH
TERMINAL - 0.25 MICROMETER GOLD IN CONTACT AREA
1.0 MICROMETER TIN-LEAD IN SOLDER TAIL
NAIL - 2.0 MICROMETER TIN-LEAD
- COPLANARITY : 0.1 mm MAXIMUM
- PRODUCT SPECIFICATION: RPS-54698-004

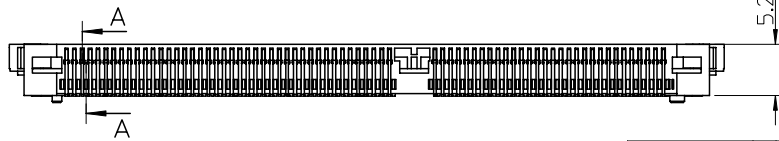

Section A-A

EC NO: SH200500073 DRWN: WFDENG 2004/11/02 CHKD: 2004/11/04 APPR: YTYAP 2004/11/05	QUALITY SYMBOLS	GENERAL TOLERANCES (UNLESS SPECIFIED)		SCALE 2:1	DESIGN UNITS METRIC	THIRD ANGLE PROJECTION	REVISE ON CAD ONLY
	▴ -0 ▽ -0	mm	INCH	DIMENSION STYLE MM ONLY	TITLE	0.8 MM PITCH SODIMM 5.2H REVERSE	
	4 PLACES ± --- ± ---			DRAWN BY WILSON	DATE 00/03/09	MOLEX MOLEX INCORPORATED	
	3 PLACES ± --- ± ---			CHECKED BY MEGA LIN	DATE	MATERIAL NO. SEE TABLE	DOCUMENT NO. SD-67345-001
	2 PLACES ± 0.25 ± ---			APPROVED BY MEGA LIN	DATE	SHEET NO. 1 OF 3	
	1 PLACE ± 0.25 ± ---			THIS DRAWING CONTAINS INFORMATION THAT IS PROPRIETARY TO MOLEX INCORPORATED AND SHOULD NOT BE USED WITHOUT WRITTEN PERMISSION			
	DRAFT WHERE APPLICABLE MUST REMAIN WITHIN DIMENSIONS		A3				

9 8 7 6 5 4 3 2 1

10 9 8 7 6 5 4 3 2 1

PART NO.	COLOR	PACKAGING
67345-0000	BLACK	PK-67345-001 (SOFT TRAY)
67345-0100	BLACK	PK-67345-002 (SEMI-HARD TRAY)

F E D C B A

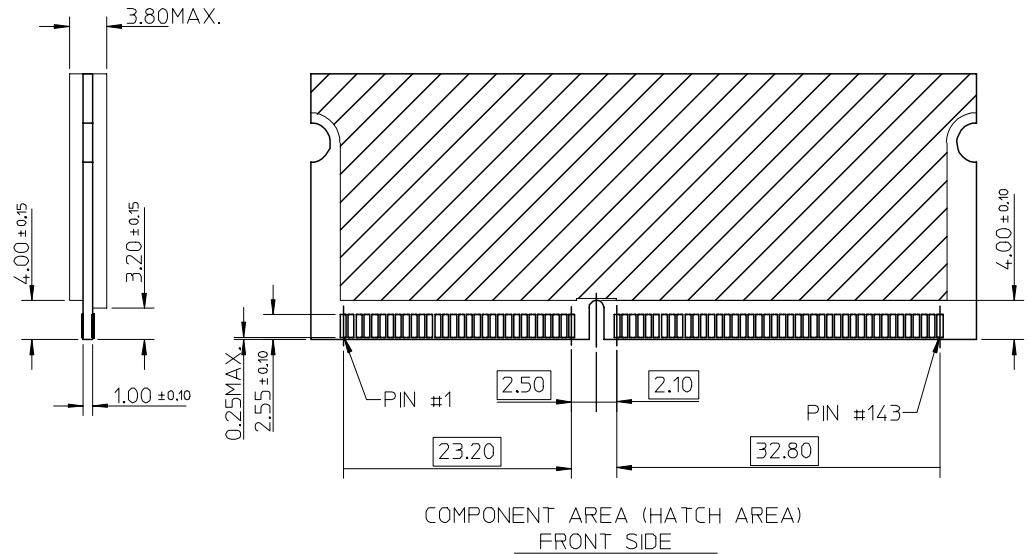
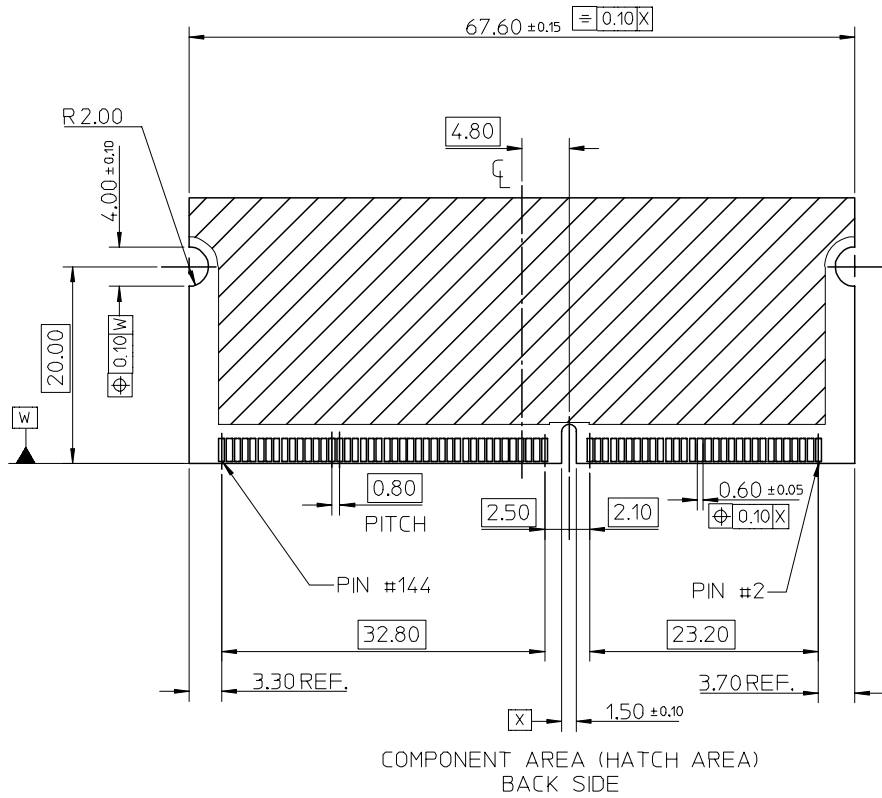

B A

EC NO: SH200500073 DRWN: WFDENG 2004/11/02 CHKD: 2004/11/04 APPR: YTYAP 2004/11/05	QUALITY SYMBOLS	GENERAL TOLERANCES (UNLESS SPECIFIED)	SCALE 2:1	DESIGN UNITS METRIC	THIRD ANGLE PROJECTION	REVISE ON CAD ONLY															
	-0 -0	<table border="1"> <thead> <tr> <th></th> <th>mm</th> <th>INCH</th> </tr> </thead> <tbody> <tr> <td>4 PLACES</td> <td>\pm ---</td> <td>\pm ---</td> </tr> <tr> <td>3 PLACES</td> <td>\pm ---</td> <td>\pm ---</td> </tr> <tr> <td>2 PLACES</td> <td>± 0.25</td> <td>\pm ---</td> </tr> <tr> <td>1 PLACE</td> <td>± 0.25</td> <td>\pm ---</td> </tr> </tbody> </table>		mm	INCH	4 PLACES	\pm ---	\pm ---	3 PLACES	\pm ---	\pm ---	2 PLACES	± 0.25	\pm ---	1 PLACE	± 0.25	\pm ---	DIMENSION STYLE MM ONLY	TITLE	0.8 MM PITCH SODIMM 5.2H REVERSE	
			mm	INCH																	
		4 PLACES	\pm ---	\pm ---																	
3 PLACES	\pm ---	\pm ---																			
2 PLACES	± 0.25	\pm ---																			
1 PLACE	± 0.25	\pm ---																			
ANGULAR $\pm 2^\circ$	DRAFT WHERE APPLICABLE	DRAWN BY WILSON CHECKED BY MEGA LIN APPROVED BY MEGA LIN	DATE 00/03/09 DATE DATE	MOLEX INCORPORATED																	
MUST REMAIN WITHIN DIMENSIONS	THIS DRAWING CONTAINS INFORMATION THAT IS PROPRIETARY TO MOLEX INCORPORATED AND SHOULD NOT BE USED WITHOUT WRITTEN PERMISSION	MATERIAL NO. SEE TABLE DOCUMENT NO. SD-67345-001 SHEET NO. 2 OF 3	A3																		

9 8 7 6 5 4 3 2 1

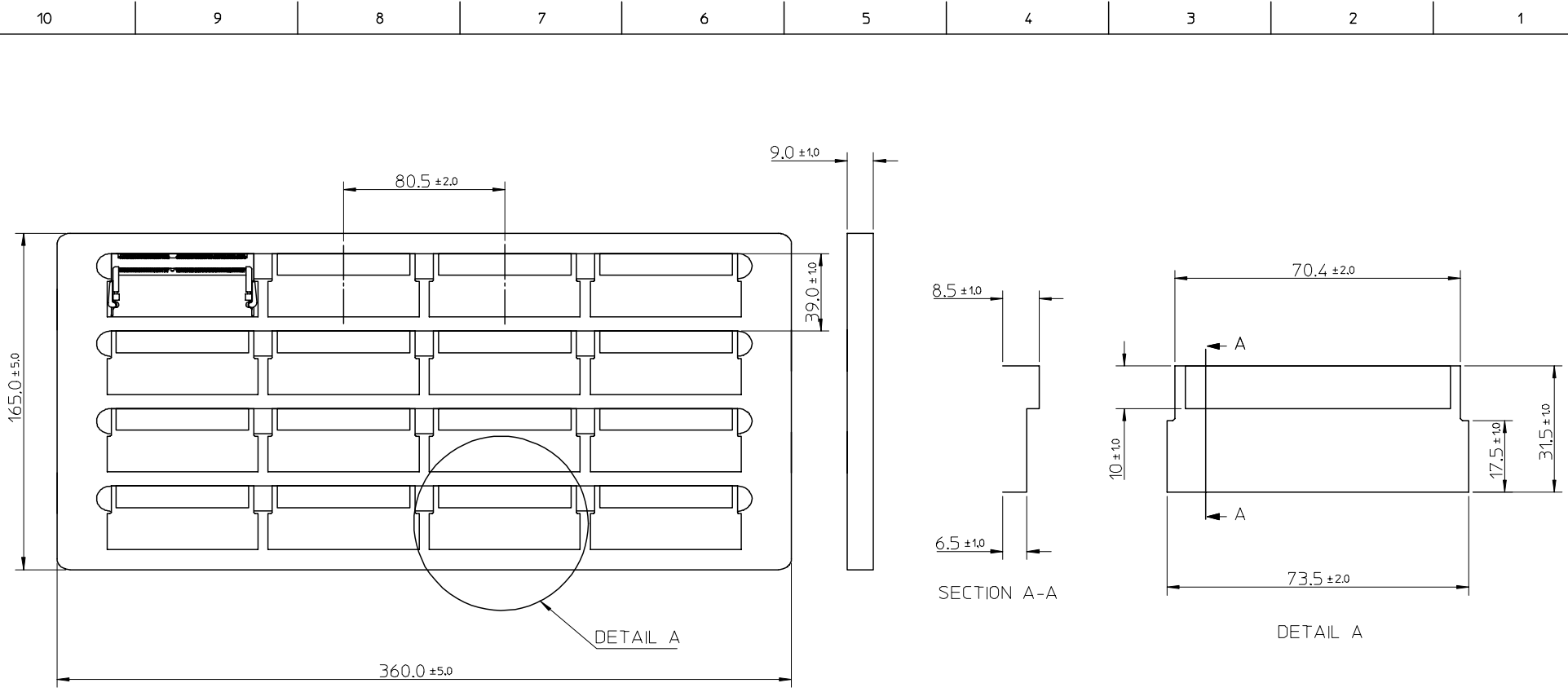

DRAWING OF TRAY PACKAGING

EC NO: S14200540873 DRWN: WFDENG 2004/11/02 CHKD: 2004/11/04 APPR: YTYAP 2004/11/05	QUALITY SYMBOLS	GENERAL TOLERANCES (UNLESS SPECIFIED)		SCALE N/A	DESIGN UNITS METRIC	THIRD ANGLE PROJECTION	REVISE ON CAD ONLY	
	 		mm	INCH	DIMENSION STYLE MM ONLY		TITLE	
		4 PLACES	± ---	± ---	DRAWN BY	DATE	0.8 MM PITCH SODIMM 5.2H REVERSE	
		3 PLACES	± ---	± ---	WILSON	00/03/09	MOLEX INCORPORATED	
	2 PLACES	± 0.25	± ---	CHECKED BY	DATE	MATERIAL NO.	DOCUMENT NO.	
	1 PLACE	± 0.25	± ---	MEGA LIN		SEE TABLE	SD-67345-001	
	ANGULAR ± 2 °		DRAFT WHERE APPLICABLE MUST REMAIN WITHIN DIMENSIONS		APPROVED BY	DATE	SHEET NO.	
					MEGA LIN		3 OF 3	
	THIS DRAWING CONTAINS INFORMATION THAT IS PROPRIETARY TO MOLEX INCORPORATED AND SHOULD NOT BE USED WITHOUT WRITTEN PERMISSION							A3